

NCOS Fall Congress

Winston-Salem Location and Parking Guide

Marriott Winston-Salem - Congress hotel

425 N Cherry St.

Where registration and all CE/meetings will take place (2nd floor)

Valet Parking Only

Up to 4 hours	\$20.00
4-8 hours	\$23.00
Over 8 hours and overnight parking	\$28.00

Benton Convention Center

301 W 5th St.

Where Partner lunches and Saturday evening event will take place (main and lower levels)

LAZ Parking Deck – located directly across from Marriott / next to Embassy Suites

402 N Cherry St.

Skywalk available from 2nd level of parking deck to 2nd floor of Marriott. Elevator in skywalk leads to lower level of Benton Convention Center.

1 hour	\$4.00
2 hours	\$7.00
4 hours	\$9.00
Up to 12 hours	\$12.00
Up to 24 hours	\$20.00
Pre-paid parking with in/out privileges	\$25.00
Lost ticket	\$60.00

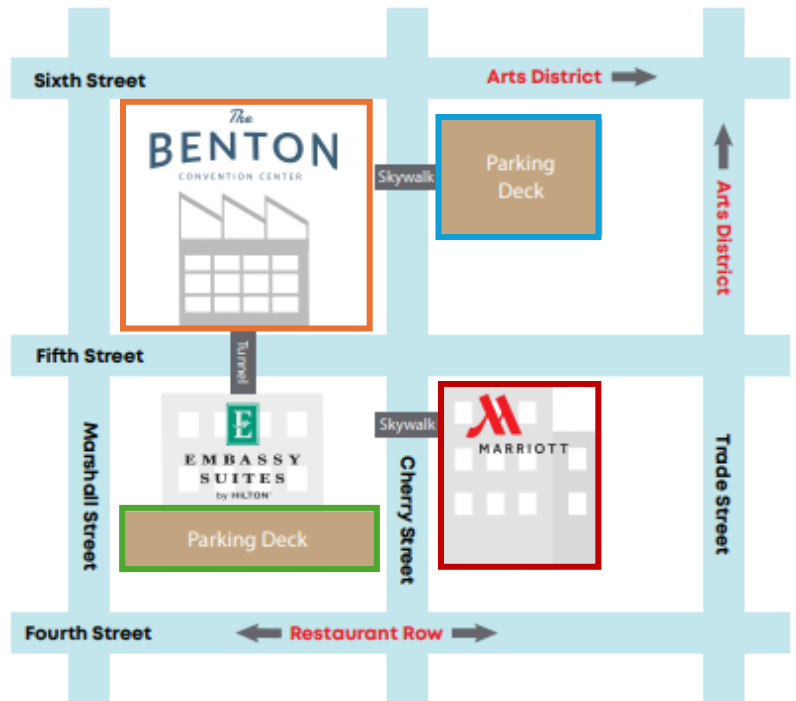

City of Winston-Salem Parking Deck – located ½ block from Marriott / across from Benton Convention Center

527 N Cherry St.

Skywalk available from 3rd level of parking deck to main level of Benton Convention Center

Monday – Friday 6:30 am – 5:30 pm

Every hour	\$1.00
Max and overnight	\$9.00

Evenings and Weekends

Monday – Friday (after 5:30 pm)	\$2.00 Flat
Saturday and Sunday all day	\$2.00 Flat

NCOS Fall Congress

Winston-Salem Location and Parking Guide

Marriott Winston-Salem Floor Plan

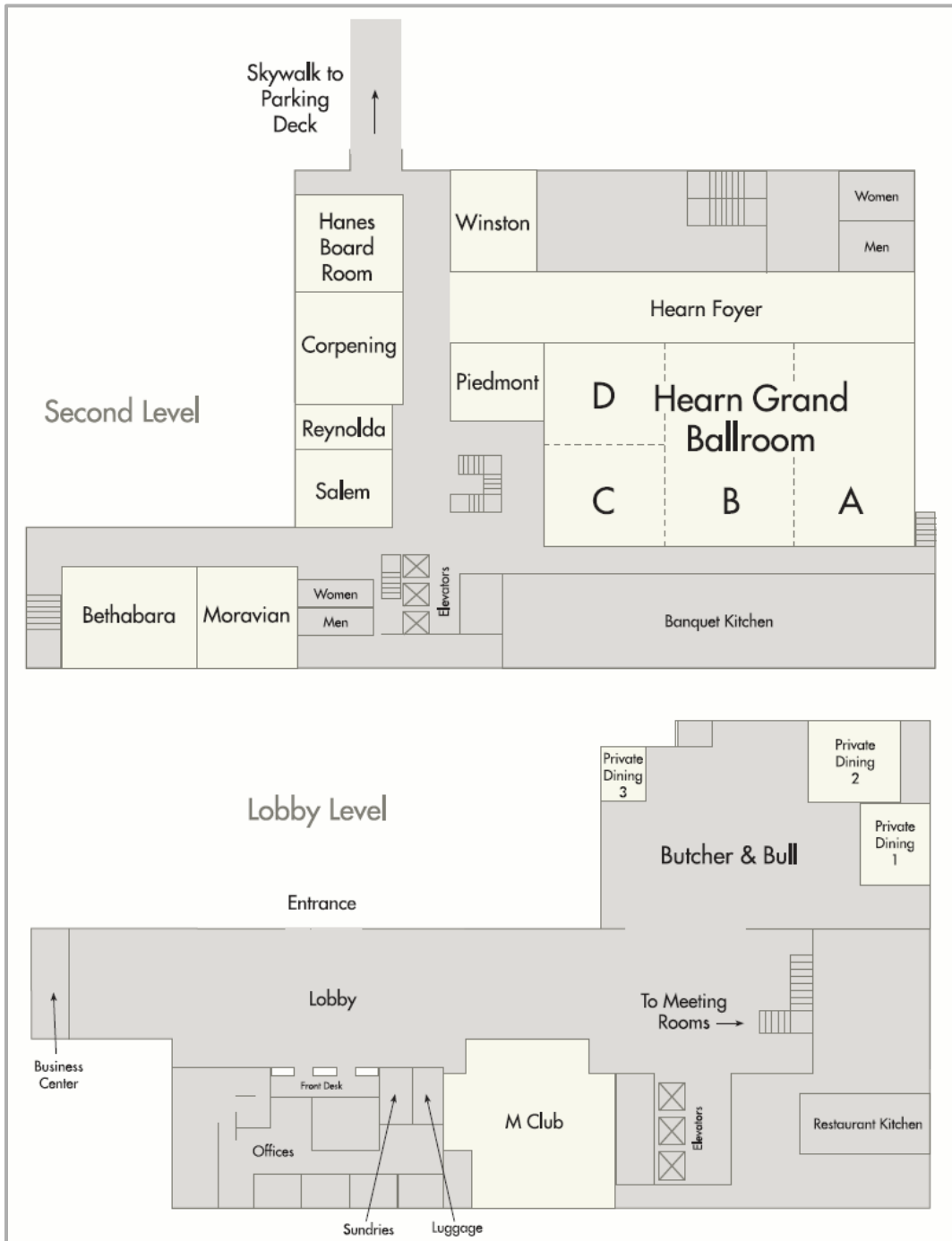

NCOS Fall Congress

Winston-Salem Location and Parking Guide

Benton Convention Center Floor Plan – Lower Level

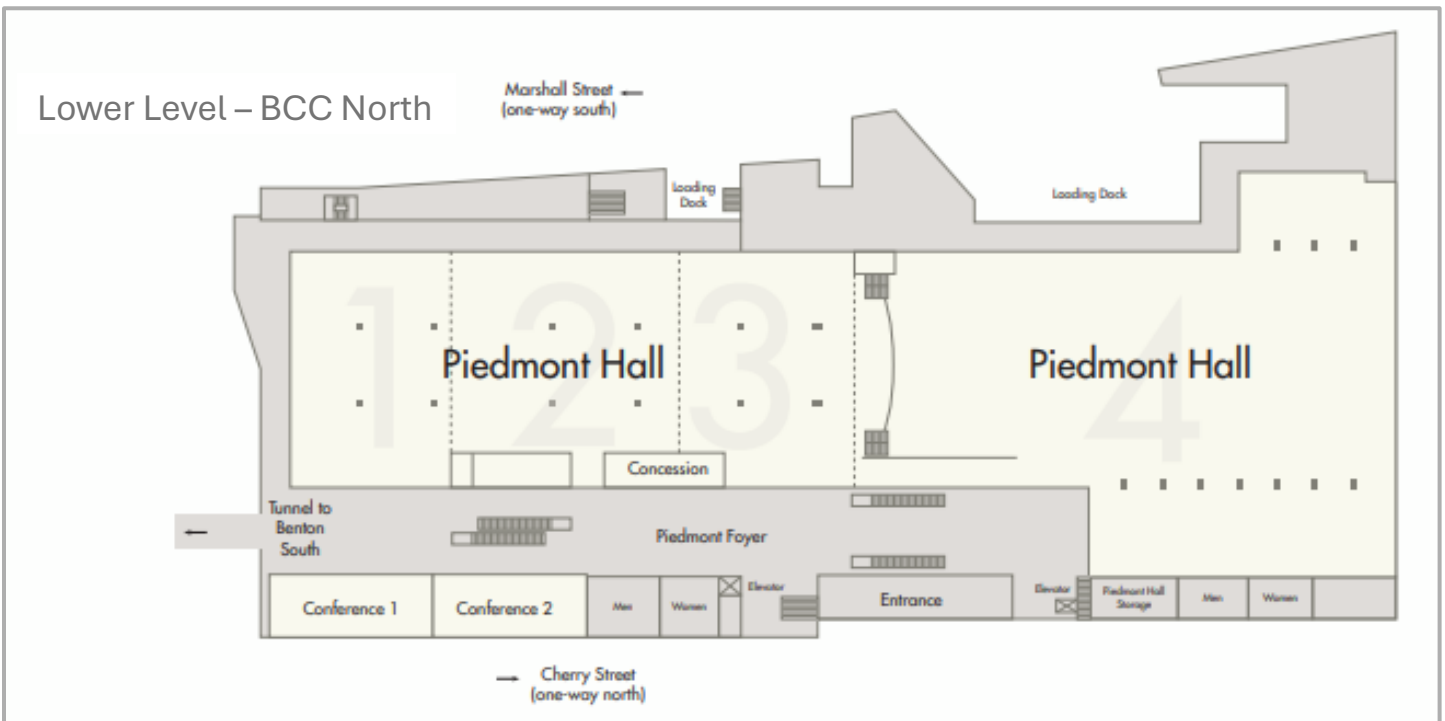
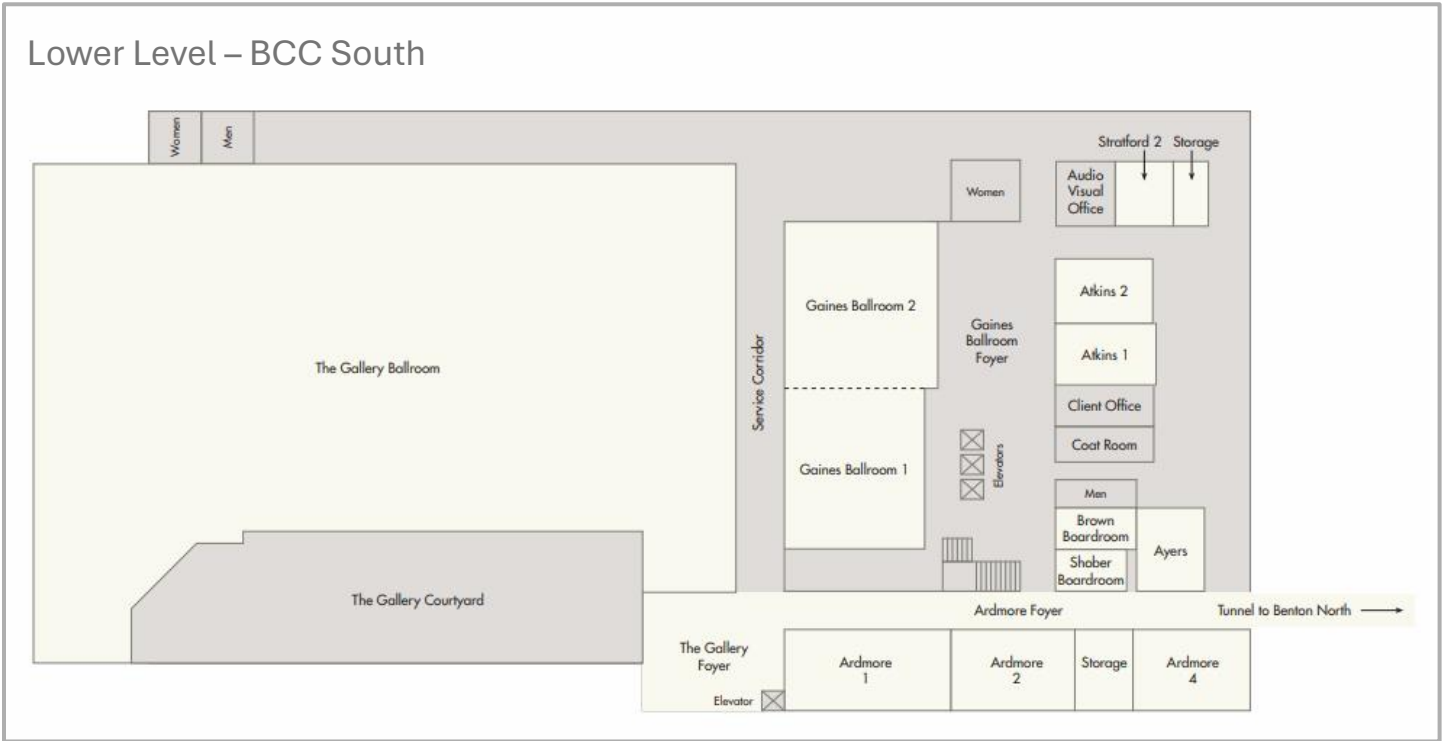

NCOS Fall Congress

Winston-Salem Location and Parking Guide

Benton Convention Center Floor Plan – Main Level

